

[IE29-425T]
3-Way Straight Bldg Connection - 4" NPT x (3) 2.5" NPT

DESCRIPTION:

A cast-brass building connection rated for operating pressures up to 175 psi (1206 kPa). Each 2.5" connection has a rated flow of 250 gpm, allowing the connection to supply a minimum capacity of 750 GPM.

This item features three (3) 2.5" NPT connections with 6.8" centers and one (1) 4" NPT connection in a straight body configuration.

FINISH:

Cast Brass



Dimensions:

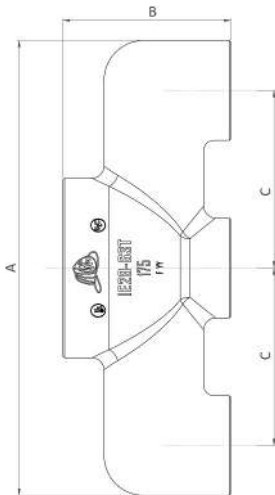

- A:** 17" (431.8 mm)
- B:** 6" (152.4 mm)
- C:** 6.8" (173.4 mm)

PROJECT	APPROVAL STAMP
PROJECT:	<input type="checkbox"/> APPROVED
ADDRESS:	<input type="checkbox"/> APPROVED AS NOTED
ENGINEER:	<input type="checkbox"/> NOT APPROVED
SUBMITTAL DATA:	REMARKS:
NOTES 1:	
NOTES 2:	