

[HF42AL-RED-2.5"]
2.5" Red Al Cap w/ Chain



2.5" (65mm) threaded Aluminum cap & chain for protection of male outlet threads on valves and hydrants. Also, prevents entry of foreign material. Specify regional hose thread.

FINISH: Cast, Red colour.

OPTIONS: Polished Chrome or Cast Brass

HOSE THREADS AVAILABLE: NST

Others available upon request.

Dimensions:

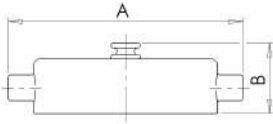

A= 4.33" (110mm)

B= 1.30" (33mm)

PROJECT	APPROVAL STAMP
PROJECT:	<input type="checkbox"/> APPROVED
ADDRESS:	<input type="checkbox"/> APPROVED AS NOTED
ENGINEER:	<input type="checkbox"/> NOT APPROVED
SUBMITTAL DATA:	REMARKS:
NOTES 1:	
NOTES 2:	