



**[ HF41AL-CP-2.5" ]**  
**2.5"(CP) ALUM PLUG & CHAIN**



2.5" (65mm) threaded Aluminum male plug & chain for protection of female threads used on fire department inlet connections. Also, prevents entry of foreign material. Specify regional hose thread.

**FINISH:** Aluminum Chrome Colour

**OPTIONS:** Red or Brass Colour

**HOSE THREADS AVAILABLE:** BCT, NST, CSA & New York Corp.

Contact Factory for other hose threads

**Dimensions:**

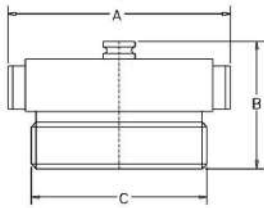

A = 4.19" (106.50 mm)  
B = 1.97" (50.07 mm)  
C = Subject to Hose Thread

PROJECT	APPROVAL STAMP
PROJECT:	<input type="checkbox"/> APPROVED
ADDRESS:	<input type="checkbox"/> APPROVED AS NOTED
ENGINEER:	<input type="checkbox"/> NOT APPROVED
SUBMITTAL DATA:	REMARKS:
NOTES 1:	
NOTES 2:	