

[IE33P-BR 4.0]

Cast Brass Round Plate for Exposed F.D.C. with 4" NPS Hole

INFORMATION:

4" NPS (DN 100) round, cast-brass plate used to identify and trim exposed fire department connections. Various lettering options are available (see below).



FINISH:

Brass

OPTIONS:

Chrome or Red

LETTERING AVAILABLE:

- Standpipe
- Auto Sprinkler/Standpipe
- Pump Test
- Auto Sprinkler
- Wall Hydrant
- Gicleurs Auto
- Canalisation d'Incendie
- Borne Murale
- Essai de Pompe
- Gicleurs Auto/Canalisation

Dimensions:

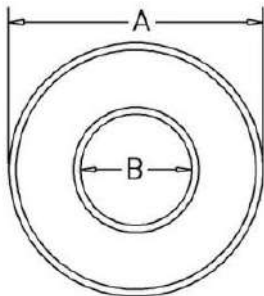

- A:** 10" (254mm)
- B:** 4.5" (114mm)

PROJECT	APPROVAL STAMP
PROJECT:	<input type="checkbox"/> APPROVED
ADDRESS:	<input type="checkbox"/> APPROVED AS NOTED
ENGINEER:	<input type="checkbox"/> NOT APPROVED
SUBMITTAL DATA:	REMARKS:
NOTES 1:	
NOTES 2:	