

[HF41CP 2.5]
2.5" Chromed Plug & Chain

2.5" (65mm) threaded brass, chrome plated male plug & chain for protection of female threads used on fire department inlet connections. Also, prevents entry of foreign material. Specify regional hose thread.



FINISH: Chrome

OPTIONS: Cast Brass or Polish Brass

HOSE THREADS AVAILABLE: CSA, BCT, WCT, QST, NSST, NPSH, NST, Louisville, Cleveland, Chicago, Pittsburgh, New Cincinnati, New York Corp., New York Fire Department, Richmond and Raleigh

Dimensions:

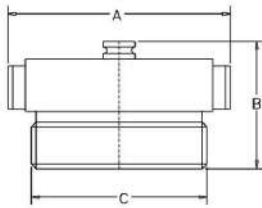

A = 4.19" (106.50 mm)
B = 1.97" (50.07 mm)
C = Subject to Hose Thread

PROJECT	APPROVAL STAMP
PROJECT:	<input type="checkbox"/> APPROVED
ADDRESS:	<input type="checkbox"/> APPROVED AS NOTED
ENGINEER:	<input type="checkbox"/> NOT APPROVED
SUBMITTAL DATA:	REMARKS:
NOTES 1:	
NOTES 2:	